

- LEGEND**
- SITE PROPERTY BOUNDARY
 - PROPOSED LOT BOUNDARIES
 - EXISTING ADJOINING LOT BOUNDARIES
 - DA APPROVED LOT BOUNDARIES
 - EASEMENT
 - FINISHED SURFACE CONTOURS
 - (A) EXISTING EASEMENT FOR WATER SUPPLY AND SEWERAGE PIPELINES VARIABLE WIDTH (X879764, DP639644, GAZ.28-7-1988 FOL.4002)
 - (B) PROPOSED EASEMENT TO DRAIN WATER 1.5m WIDE
 - (C) PROPOSED EASEMENT FOR MULTI-PURPOSE ELECTRICAL INSTALLATION 4.2m x 7m
 - (D) PROPOSED EASEMENT FOR UNDERGROUND POWERLINES 4.2m x 1m
 - (F) PROPOSED EASEMENT FOR DRAINAGE 6m & 27.5m WIDE
 - EXISTING TREE TO BE RETAINED
 - EXISTING TREE TO BE REMOVED
 - EXISTING EDGE OF TREES
 - PROPOSED STREET TREES REFER TO LANDSCAPE PLAN SHEET 43
 - EXISTING SEWER MAIN
 - EXISTING SEWER MANHOLE
 - EXISTING WATER MAIN
 - EXISTING WATER MAIN STOP VALVE AND HYDRANT
 - EXISTING NON POTABLE WATERMAIN
 - EXISTING STORMWATER
 - EXISTING TELSTRA SERVICE AND PIT
 - EXISTING FENCE
 - EXISTING STREET SIGN
 - EXISTING LIGHTPOLE
 - EXISTING POWER POLE
 - STORMWATER PIT LABEL
 - STORMWATER (INC MINOR LINES)
 - STORMWATER GGP, GRATED PIT, JUNCTION PIT AND JUNCTION
 - POTABLE WATERMAIN
 - NON-POTABLE WATERMAIN
 - GRAVITY SEWER (INC MINOR LINES), MAINTENANCE SHAFT, AND JUNCTION
 - STREET NAME SIGN
 - SSM TO BE INSTALLED
 - PROPOSED CONCRETE FOOTPATH
 - PROPOSED ASPHALTIC CONCRETE ROAD
 - PROPOSED CONCRETE ROAD
 - PROPOSED CONCRIB RETAINING WALL OR APPROVED EQUIVALENT, REFER TO EARTHWORKS AND EROSION SHEET 06 FOR LEVELS AND SHEET 26 FOR TYPICAL RETAINING WALL DETAILS
 - CONSTRUCT EARTH BANK FLOW IN ACCORDANCE WITH MANAGING URBAN STORMWATER - SOILS & CONSTRUCTION VOL. 1, SD 5-5

PIT SCHEDULE
REFER SHEET 06 FOR STORMWATER PIT SCHEDULE

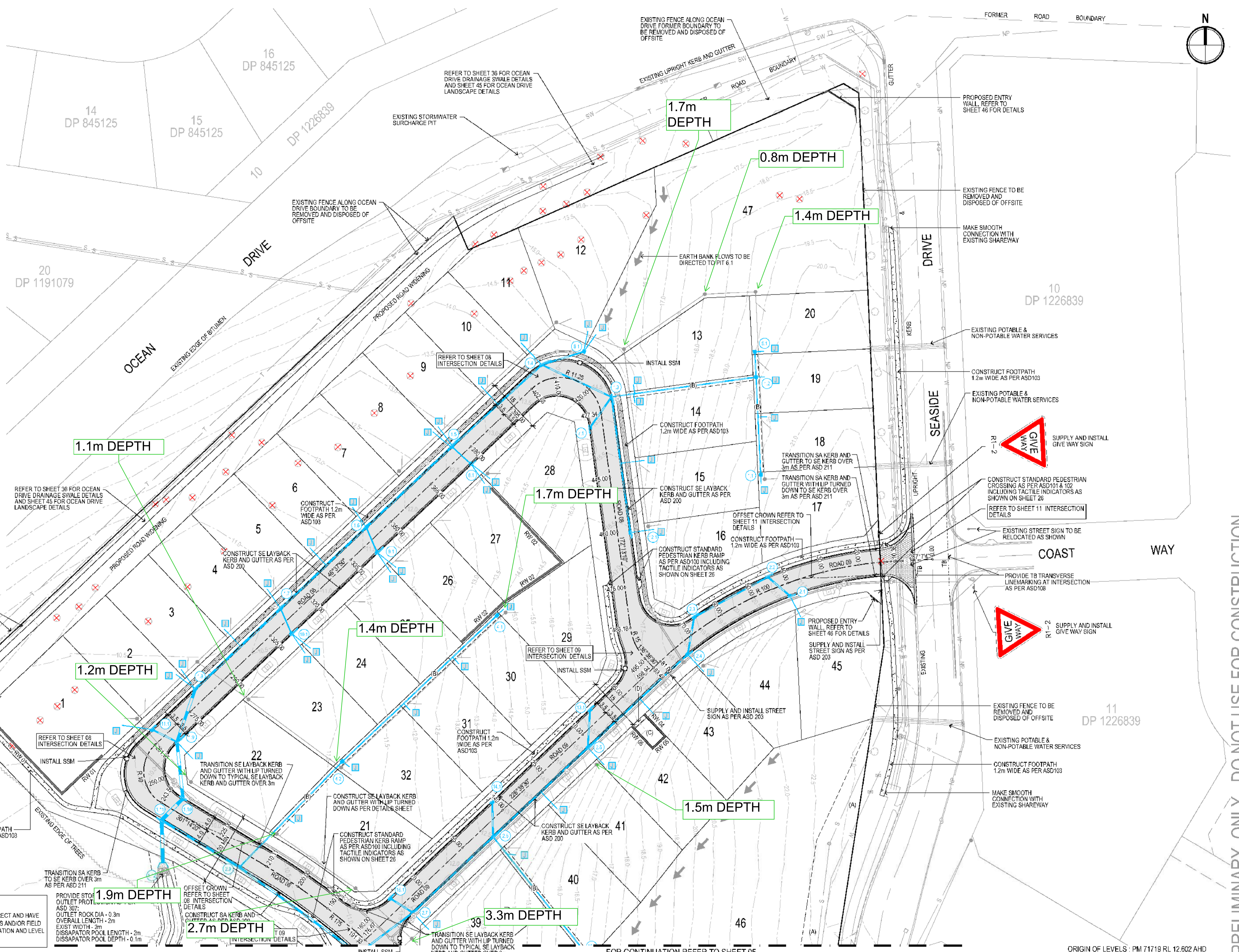

NOTE
EXISTING SERVICES SHOWN ON THIS PLAN ARE NOT GUARANTEED COMPLETE OR CORRECT AND HAVE BEEN SOURCED FROM INFORMATION SUPPLIED BY THE RELEVANT SERVICE AUTHORITIES AND/OR FIELD INVESTIGATIONS. IT IS THE RESPONSIBILITY OF THE CONTRACTOR TO CONFIRM THE LOCATION AND LEVEL OF ALL SERVICES PRIOR TO THE COMMENCEMENT OF WORK.



PRELIMINARY ONLY - DO NOT USE FOR CONSTRUCTION

REV.	DATE	DESCRIPTION	BY
A	19.05.2017	ISSUED FOR CONSTRUCTION CERTIFICATE APPLICATION	SC

DATUM:	AHD
SCALE:	1:500 @ A1 (1:1000 @ A3)

PROJECT NO.:	3/09
DA NO.:	2016/042
DESIGNED BY:	SC / SM
DRAWN BY:	SC
CHECKED BY:	SM
DATE CREATED:	MARCH 2017

DRAWING TITLE:	ROADWORKS AND DRAINAGE PLAN 01
PROJECT:	PRECINCT E, PROPOSED SUBDIVISION OF LOT 64 DP 1226839, LOTS 1, 2, 3 & 4 DP 1150758 AND LOT 5 DP 25886, OCEAN DRIVE LAKE CATHIE
CLIENT:	ST VINCENT'S FOUNDATION



McCREE 03/10/2016: 561/roadworksanddrainage01.dwg: E:\Projects\1431\1431_Plan_01_19_Aug_2017.dwg